

GD Covers (GD)

Double-edged cap for the protection of solenoid valve terminals during transport. The cap fits standard DIN 43 650 plugs.

Applications:

GD range is recommended for protection of of solenoid valve terminals in the automotive segment.

Main features:



Ideal solution for solenoid valve terminals



Suitable for Automotive segment



Excellent protection against dust & other contaminants



Made of RECYCLE LDPE & TPE



Fits standard DIN 43 650 plugs

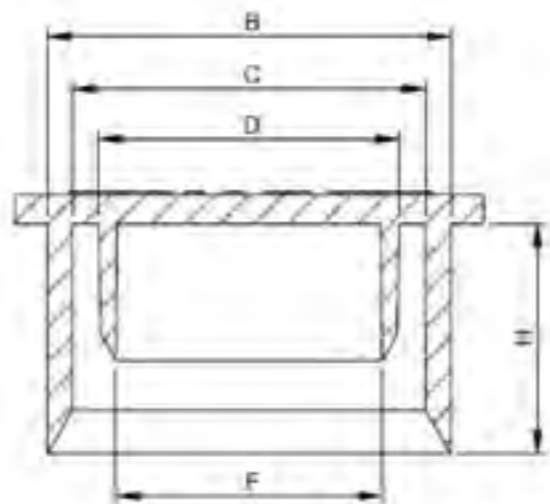

Properties

Standard colour: Blue- Other colors may be available upon request

Standard material: RECYCLE LDPE

DBI Ref.	B mm	C mm	D mm	F mm	H mm	Color	QTY Bag/Box
GD0214A -AA	21,1	18,5	15,7	13,9	12,0	Natural	500/6000

Standard colour: Orange- Other colors may be available upon request

Standard material: TPE

DBI Ref.	B mm	C mm	D mm	F mm	H mm	Color	QTY Bag/Box
GD0176A -TB	-	17,6	10,3	-	13,5	Orange	500/5000
GD0195A -TB	-	19,5	12,0	-	15,5	Orange	500/5000
GD0326A -TB	-	32,6	24,7	18,6	25,0	Pink	200/1800
GD0326B -TB	-	32,6	24,7	18,6	25,0	Blue	200/1600
GD0328A -TB	-	32,5	-	16,0	16,5	Orange	250/2500