

Parallel Plugs Type (NC) Breathable membranes

Universal closure that is mostly used as external protection. The reduced-weight design makes this plug cost-effective. It is recommended for fittings and connection ports.

Applications:

NC range is recommended for protection of fittings and connection ports in the automotive segment.

Main features:



Ideal solution for fittings & connection ports



Air circulation feature



Universal closure & reduced-weight design



Made of RECYCLE LDPE



Easy mounting & dismounting

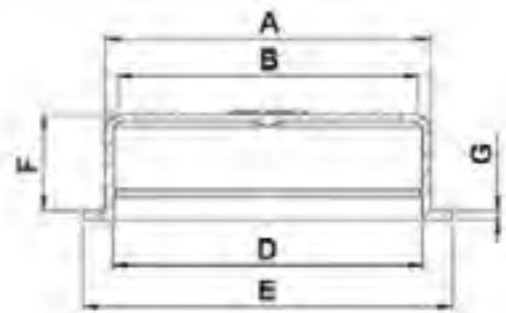

Properties

Standard colour: Red- Other colors may be available upon request

Standard material: RECYCLE LDPE

DBI Ref.	A mm	B mm	D mm	F mm	G mm	External diameter of pipe in mm	SDR-Standard Dimension Ratio
NC3120N-AA	311,8	307,2	308,0	38,3	1,2	355,0	17,0
NC3321N-AA	328,0	317,0	323,0	38,7	1,2	400	11,0
NC3540N-AA	354,0	349,0	347,0	38,5	1,2	400	17,0