

Parallel Plugs Type (NC)

Universal closure that is mostly used as external protection. The reduced-weight design makes this plug cost-effective. It is recommended for fittings and connection ports.

Applications:

NC range is recommended for protection of fittings and connection ports in the automotive segment.

Main features:



Ideal solution for fittings & connection ports



Suitable for Automotive segment



Universal closure & reduced-weight design



Made of RECYCLE LDPE & HDPE



Easy mounting & dismounting

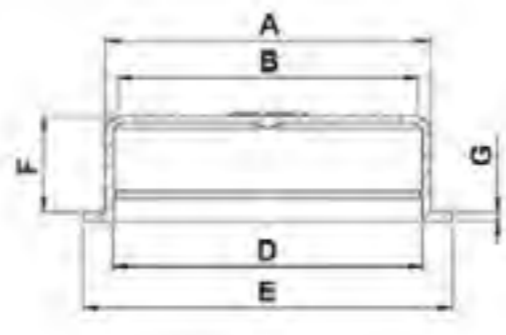

Properties

Standard colour: Red- Other colors may be available upon request

Standard material: RECYCLE LDPE

DBI Ref.	A mm	B mm	D mm	E mm	F mm	G mm	QTY Bag/Box
NC0130Z-AA	13,0	-	11,9	16,9	7,7	-	0/2500
NC0270Z-AA	27,0	-	-	31,0	10,0	-	1000/2000
NC0350Z-AA	35,0	35,0	33,0	39,0	8,0	-	0/5000
NC0360A-AV	36,0	33,3	34,1	40,8	10,6	1,1	500/5500
NC0400Z-AA	40,0	40,0	38,0	47,0	8,0	-	0/4000
NC0520A-AA	52,0	47,1	50,5	58,0	10,7	1,0	200/3000
NC0773A-AA	79,6	79,6	76,3	87,5	14,0	1,3	100/800

Parallel Plugs Type (NC)

Breathable membranes

Universal closure that is mostly used as external protection. The reduced-weight design makes this plug cost-effective. It is recommended for fittings and connection ports.

Applications:

NC range is recommended for protection of fittings and connection ports in the automotive segment.

Main features:



Ideal solution for fittings & connection ports



Air circulation feature



Universal closure & reduced-weight design



Made of RECYCLE LDPE



Easy mounting & dismounting

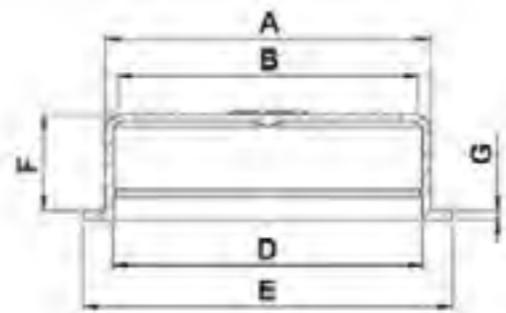

Properties

Standard colour: Red- Other colors may be available upon request

Standard material: RECYCLE LDPE

DBI Ref.	A mm	B mm	D mm	F mm	G mm	External diameter of pipe in mm	SDR-Standard Dimension Ratio	QTY Bag/Box
NC3120N-AA	311,8	307,2	308,0	38,3	1,2	355,0	17,0	15/105
NC3321N-AA	328,0	317,0	323,0	38,7	1,2	400	11,0	15/105
NC3540N-AA	354,0	349,0	347,0	38,5	1,2	400	17,0	15/105